



Materialspecifikation

Inåtgående fönster

UHI Underkantshängt

Handtag	Hoppe Atlanta Löst levererade
---------	----------------------------------

Spanjolett	Siegenia
------------	----------

Vädringsbeslag	Siegenia
----------------	----------

Beslag	Fiskars bultgångjärn
--------	----------------------

Karmdjup	85 mm
----------	-------

Format begränsning	Alt.max 50 kg bägvikt Max bredd 1600 mm Min bredd 385 mm Max höjd 1600 mm Min höjd 540 mm
--------------------	---

NOTE	AM-NO.	ALTERATION	DATE	SIGN
------	--------	------------	------	------

Produkttyp:
DK
SHI

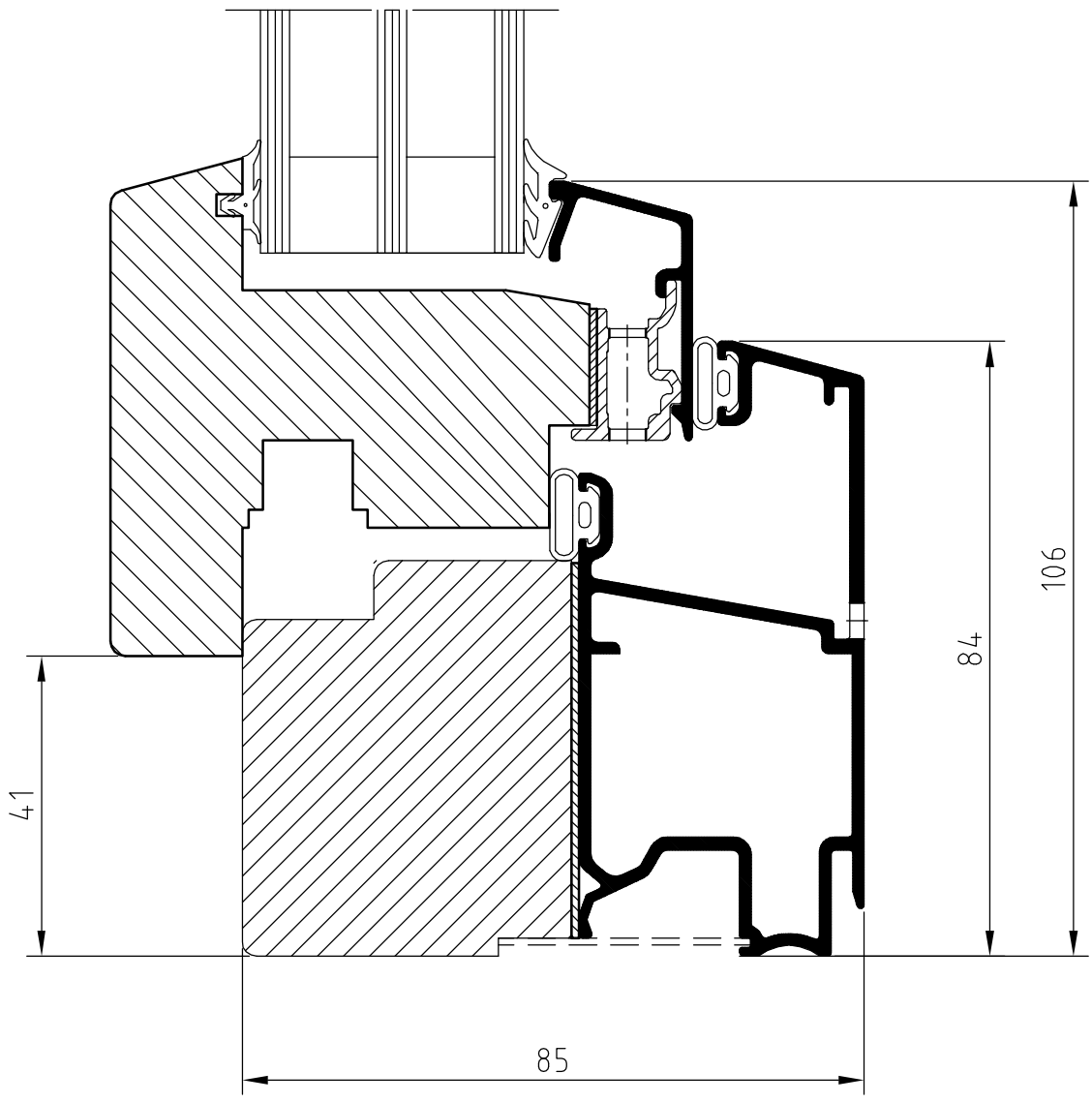
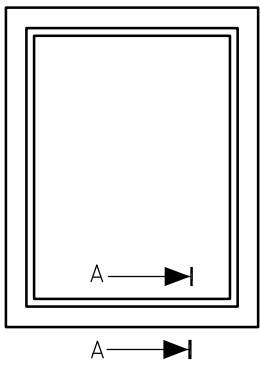

<i>Westcoast windows AB</i>	INÅTGÅENDE SYSTEM	Scale 1:1	Designer	Date 020930
	451 55 Uddevalla Sweden	UNDER 3-GLAS	REF.NO.	Rev A
			DRAW.NO.	DK-003

NOTE	AM-NO.	ALTERATION	DATE	SIGN
------	--------	------------	------	------

Produkttyp:
DK-2
SHI-2

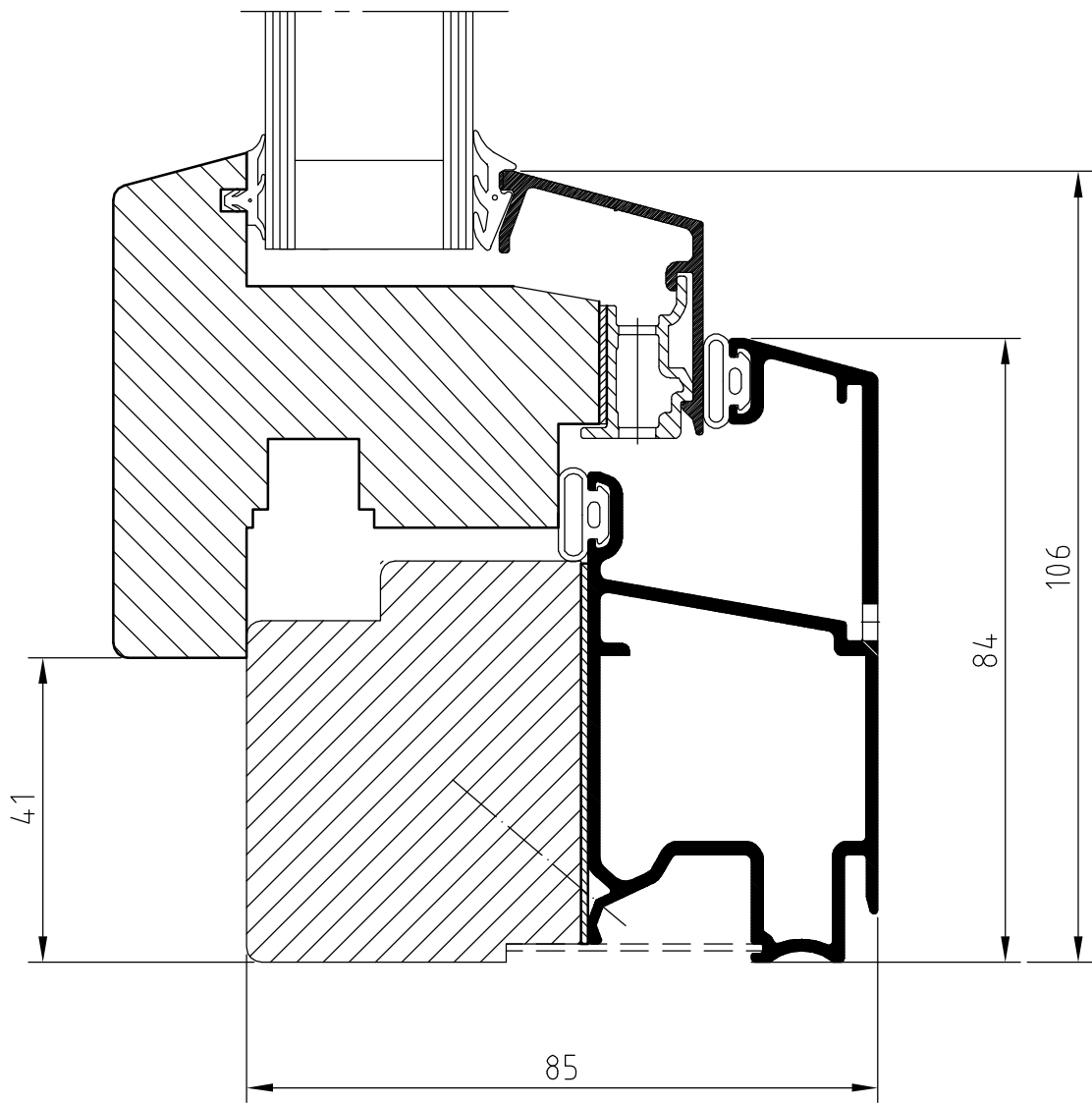
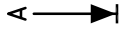
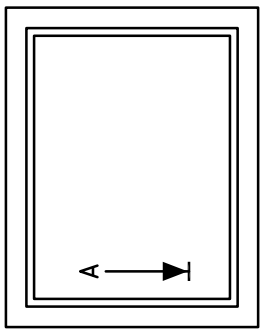

<i>Westcoast windows AB</i> 451 55 Uddevalla Sweden	INÅTGÅENDE SYSTEM	Scale 1:1	Designer	Date 040113
	UNDER 2-GLAS	REF.NO.	Rev A	
		DRAW.NO.	DK-013	